

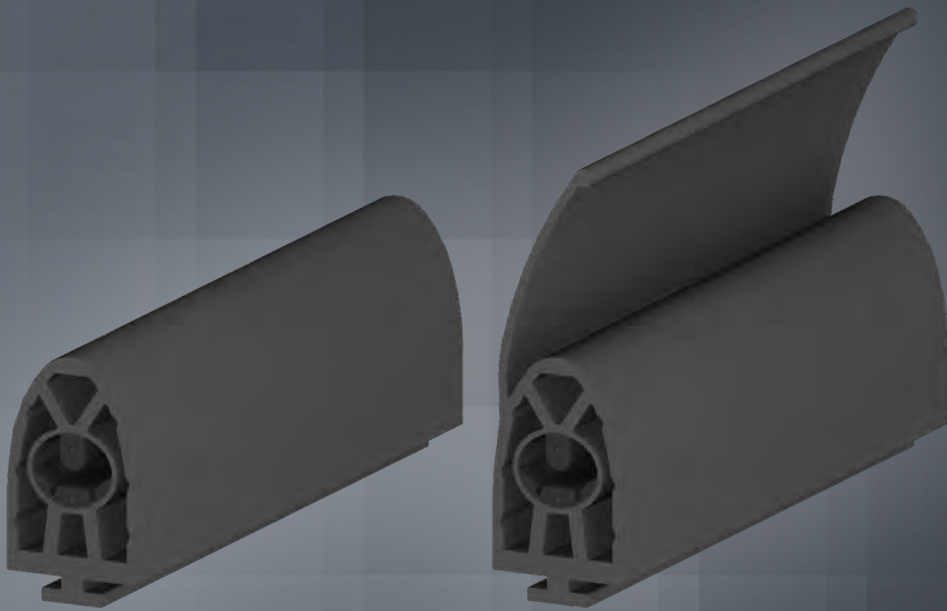

SENTIR®
edge

15.25



Product Information



Specifications

SENTIR edge
15.25 TT

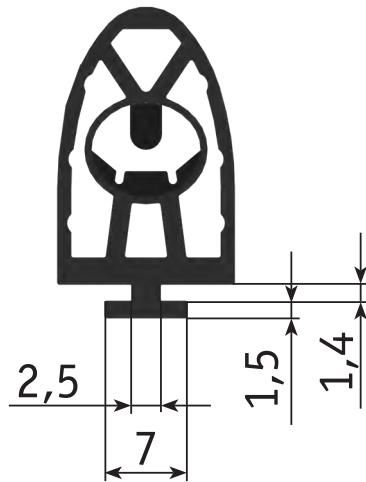

SENTIR edge
15.25 TTLi

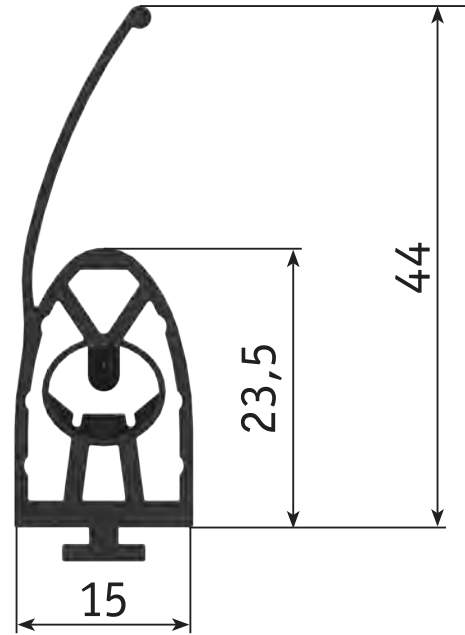

* All shown T-base variants are also available with smaller base shape „Ts“.

Max. delivery length	30 m
Dimensions	15 mm B x 23,5 mm H 15 mm W x 23,5 mm H
Certificates	EN ISO 13856-2 EN 12978 EN ISO 13849-1 UL 325

Dimension in mm, Tolerances according to DIN ISO 3302-1 class E2

Technical data

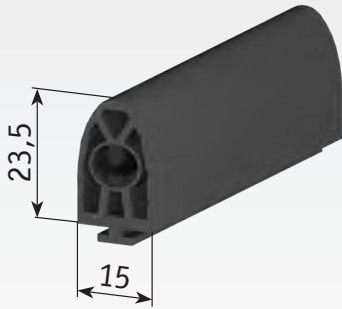

Characteristics for test temperature +20 °C

Test-Speed 10 mm/s

Betätigungskraft F ^A Actuation Force F ^A	43,0 N
Ansprechweg c Actuation distance c	3,7 mm
Nachlaufweg d bis 250 N Overtravel distance d to 250 N	7,6 mm
Nachlaufweg f bis 400 N Overtravel distance f to 400 N	9,3 mm
Nachlaufweg h-c bis 600 N Overtravel distance h-c to 600 N	10,9 mm

Test-Speed 100 mm/s

Actuation Force F ^A	52,9 N
Actuation distance c	5,2 mm
Overtravel distance d to 250 N	6,4 mm
Overtravel distance f to 400 N	7,8 mm
Overtravel distance h-c to 600 N	9,2 mm

Test-Speed 200 mm/s

Actuation Force F ^A	81,9 N
Actuation distance c	6,5 mm
Overtravel distance d to 250 N	4,8 mm
Overtravel distance f to 400 N	6,2 mm
Overtravel distance h-c to 600 N	7,4 mm



The response time of the used controller affects the measured overtravel distances of the contact edge.

General data	
Type	SENTIR edge 15.25 TT
Article No.	1502-0640
Material	TPE
Material hardness	68 Shore A
Delivery length	30 m
Weight kg/m	0,21
Enclosure	IP 67 (IP 68 on request)
Switching Cycles	10.000
Switching Angle	2 x 45°
Actuation resistance	≤ 500 Ohm
Electrical capacity	24 V 10 mA
Operating temperature	-10 °C → 50 °C
Max. temperature range	-25 °C → 75 °C
Max. length of several contact edges	100 m
Max. series connection of the contact edges	contact edges
Inactive end region with higher forces	30 mm
Connection cables	LIY11Y 2x0,34 mm ²
Cable material	PUR matt schwarz/black

Dimension in mm, Tolerances according to DIN ISO 3302-1 class E2

Tested according DIN EN ISO 13856-2, Test Unit round 80mm, Actuating Point C3, Temp. 20°C

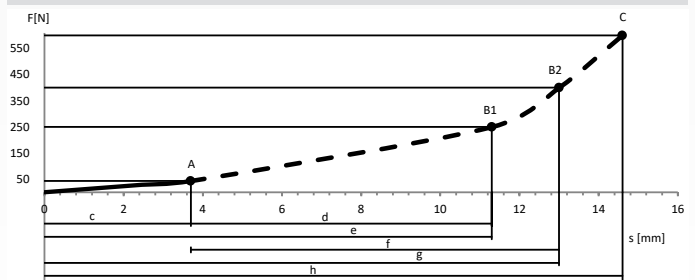

Tested according DIN EN ISO 13856-2, Test Unit round 80mm, Actuating Point C3, Temp. 20°C

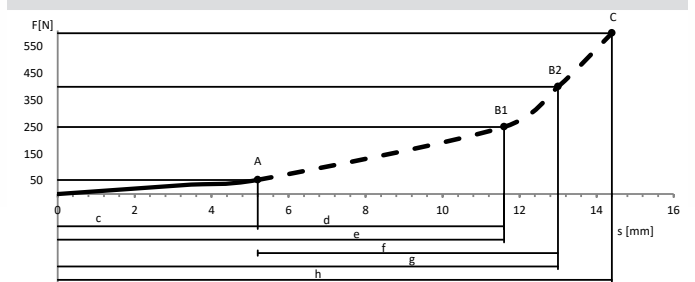

Tested according DIN EN ISO 13856-2, Test Unit round 80mm, Actuating Point C3, Temp. 20°C

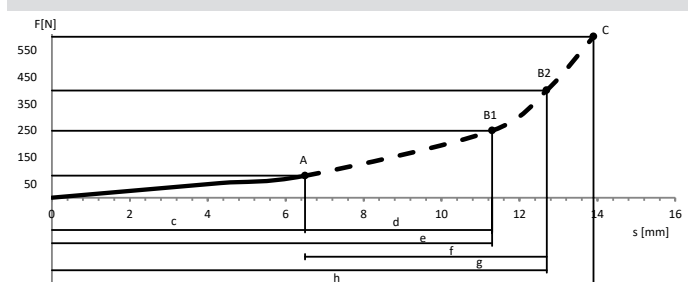

Technical data

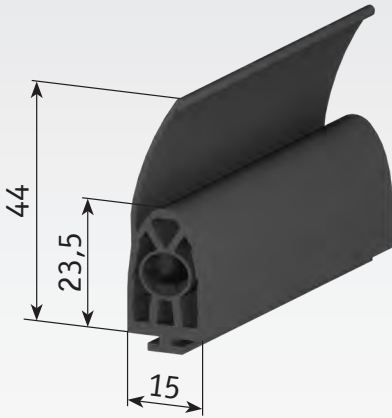

General data	
Type	SENTIR edge 15.25 TTLi
Article No.	1502-0620
Material	TPE
Material hardness	68 Shore A
Delivery length	30 m
Weight kg/m	0,22
Enclosure	IP 67 (IP 68 on request)
Switching Cycles	10.000
Switching Angle	2 x 45°
Actuation resistance	≤ 500 Ohm
Electrical capacity	24 V 10 mA
Operating temperature	-10 °C → 50 °C
Max. temperature range	-25 °C → 75 °C
Max. length of several contact edges	100 m
Max. series connection of the contact edges	5 Kontaktleisten / contact edges
Inactive end region with higher forces	30 mm
Connection cables	LIY11Y 2x0,34 mm ²
Cable material	PUR matt schwarz/black

Dimension in mm, Tolerances according to DIN ISO 3302-1 class E2

Characteristics for test temperature +20 °C

Test-Speed 10 mm/s

Actuation Force F ^A	26,4 N
Actuation distance c	2,0 mm
Overtravel distance d to 250 N	9,3 mm
Overtravel distance f to 400 N	11,2 mm
Overtravel distance h-c to 600 N	12,8 mm

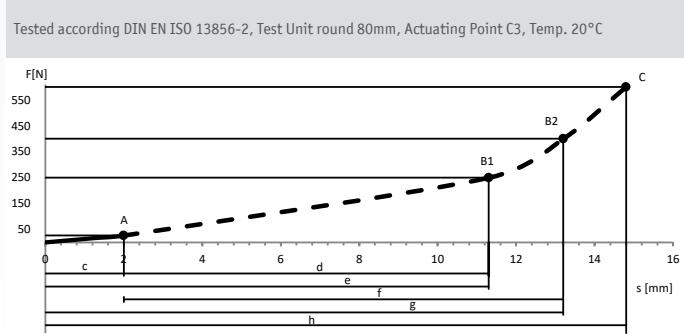

Test-Speed 100 mm/s

Actuation Force F ^A	67,8 N
Actuation distance c	3,5 mm
Overtravel distance d to 250 N	7,0 mm
Overtravel distance f to 400 N	9,2 mm
Overtravel distance h-c to 600 N	11,1 mm

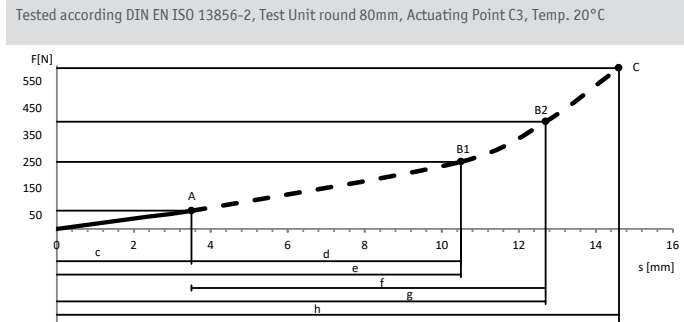

Test-Speed 200 mm/s

Actuation Force F ^A	95,7 N
Actuation distance c	6,7 mm
Overtravel distance d to 250 N	5,3 mm
Overtravel distance f to 400 N	7,1 mm
Overtravel distance h-c to 600 N	8,9 mm

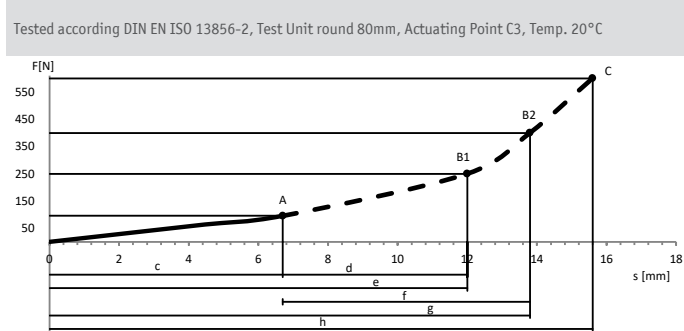

The response time of the used controller affects the measured overtravel distances of the contact edge.

Technical data

Material properties

General		
Tear strength	3	
Ultimate tensile strength	3	
Rebound elasticity at 20 °C	2	
Resistance against permanent deformation	3	
Abrasion	3	
Elongation @ Tear	3	
Cold flexibility	2	
Heat stability	2	
Oxidation stability	1	
UV-stability	1	
Weather resistance	1	
Flame resistance	6	
Ozone (50 ppm)	1	

1 = very good → 6 = insufficient

Chemical resistance		
Water (dist.)	1	
Dilutes acid	1	
Dilutes base	1	
Not oxidizing acids	2	
Oxidizing acids	2	
ASTM-oil No. 3	6	
Mineral oil	2	
Brake fluid	2-3	
Antifreezing admixture	1	
Gasoline	5	
Diesel	2-3	
Alcohol	1	

1 = no effects	Permanent contact
2 = few effects	Some contact
3 = medium effects	Some contact
4 = noticeable effects	Reduced contact
5 = severe effects	Very brief contact
6 = extreme effects	Avoid contact



The listed properties are considered as guideline. Critical application must be practically tested by the customer.

Assembly system

The KS 4 PRO Plug 'N' Sense System

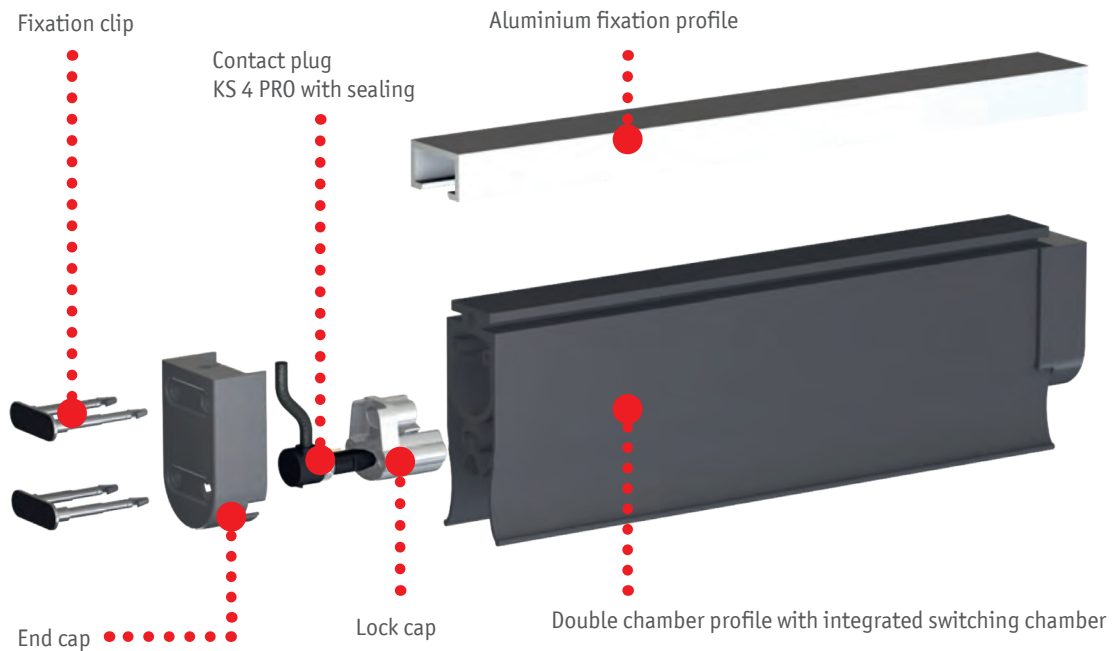

KS 4 PRO W oder L XX,Xm - 15.25-Set KS 4 PRO W or L XX,Xm - 15.25-Set

- 

1x KS 4 PRO plug with protective cap
(resistor 8.2 kOhm or XX,X m cable)
- 

1x Lock cap
- 

1x End cap 15.25

Assembly and installation instruction are available at asosafety.co.uk.

Declaration of conformity

EC Declaration of conformity (according annex II 2006/42/EC)



We hereby declare that the following products of sensing contact edges

SENTIR edge 15.25

for the combination with safety relays of the model range

- ELMON relay 31**
- ELMON relay 32**
- ELMON relay 34**
- ELMON relay 35**
- ELMON relay 39***
- ELMON relay 41***

satisfies the relevant essential health and safety requirements of the EC directives and standards listed below on account of its design and construction, as does the version brought to market by us:

- EN ISO 13856-2**
- EN 12978**
- EN ISO 13849-1**
- 2011/65/EU; 2015/863/EU RoHS**
- (EC) Nr. 1907/2006 - REACH**

*EC type-examination
 Notified Body 0044
 TÜV Nord Cert GmbH
 Langemarckstraße 20
 D-45141 Essen
 No. 44 205 13031816

This declaration of conformity does not relieve the designer / manufacturer of the machine from his obligation to ensure that the conformity of the entire machine to which this product is attached satisfies the corresponding EC directive.

Manufacturer and attorney of documents

ASO GmbH
 Hansastr. 52
 D-59557 Lippstadt
 Lippstadt, 15.06.2021



D. Verhufen
 - Geschäftsführer - CFO - Gérant -



Declaration of conformity

EC Declaration of conformity (according annex II 2006/42/EC)



We hereby declare that the following products of sensing contact edges

SENTIR edge 15.25

for the combination with safety relays of the model range

ELMON inductive 70*
ELMON inductive 71*
ELMON inductive 74*
ELMON inductive 77

satisfies the relevant essential health and safety requirements of the EC directives and standards listed below on account of its design and construction, as does the version brought to market by us:

EN ISO 13856-2
EN 12978
EN ISO 13849-1
2011/65/EU; 2015/863/EU RoHS
(EC) Nr. 1907/2006 - REACH

*EC type-examination
Notified Body 0044
TÜV Nord Cert GmbH
Langemarckstraße 20
D-45141 Essen
No. 44 205 13031816

This declaration of conformity does not relieve the designer / manufacturer of the machine from his obligation to ensure that the conformity of the entire machine to which this product is attached satisfies the corresponding EC directive.

Manufacturer and attorney of documents



D. Verhufen
- Geschäftsführer - CFO - Gérant -





www.asdltd.ie +353 0 4734550 sales@asdltd.ie

SALES TEAM

Jason Burns - National Sales Manager (Northern Counties)
IE +353 8743 25 595 NI +44 759 084 8002
jason.burns@asdltd.ie

Micheál Cronin - Sales Manager (Southern Counties)
IE +353 8742 83 008
micheal.cronin@asdltd.ie

Headquarter Europe

ASO GmbH
Hansastraße 52
59557 Lippstadt

Tel +49 2941 9793-0
Fax +49 2941 9793-299
www.asosafety.de
sales-eu@asosafety.com

Headquarter USA

ASO Safety Solutions Inc.
300 Roundhill Drive, Unit 6
Rockaway, NJ 07866

Phone +1 973 5869600
Fax +1 973 5861590
www.asosafety.com
sales-us@asosafety.com

Headquarter Asia Pacific

ASO Safety Solutions Nanjing Co. Ltd.
Jinma Lu 3 Maqun Scientific Park
210049 Nanjing

Phone +86 25 856 73990
www.asosafety.cn
sales-cn@asosafety.com



DOC0000266 Technical data Rev 05
as of 07.05.2021
Technical changes reserved